

MALE END VIEW

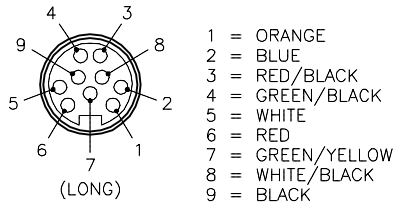

SPECIFICATIONS

|                               |                                   |
|-------------------------------|-----------------------------------|
| CONTACT CARRIER MATERIAL      | TPU                               |
| CONTACT MATERIAL/PLATING      | BRASS/GOLD                        |
| HOUSING MATERIAL/FINISH       | BRASS/NICKEL                      |
| RATED CURRENT [A]             | 7.0 A                             |
| RATED VOLTAGE [V]             | 600 V                             |
| CONDUCTOR INSULATION MATERIAL | PVC                               |
| NUMBERS OF CONDUCTORS [AWG]   | 9x14 AWG                          |
| TEMPERATURE RATING            | -40°C to +105°C (-40°F to +221°F) |
| PROTECTION CLASS              | MEETS NEMA 1,3,4,6P AND IEC IP68  |

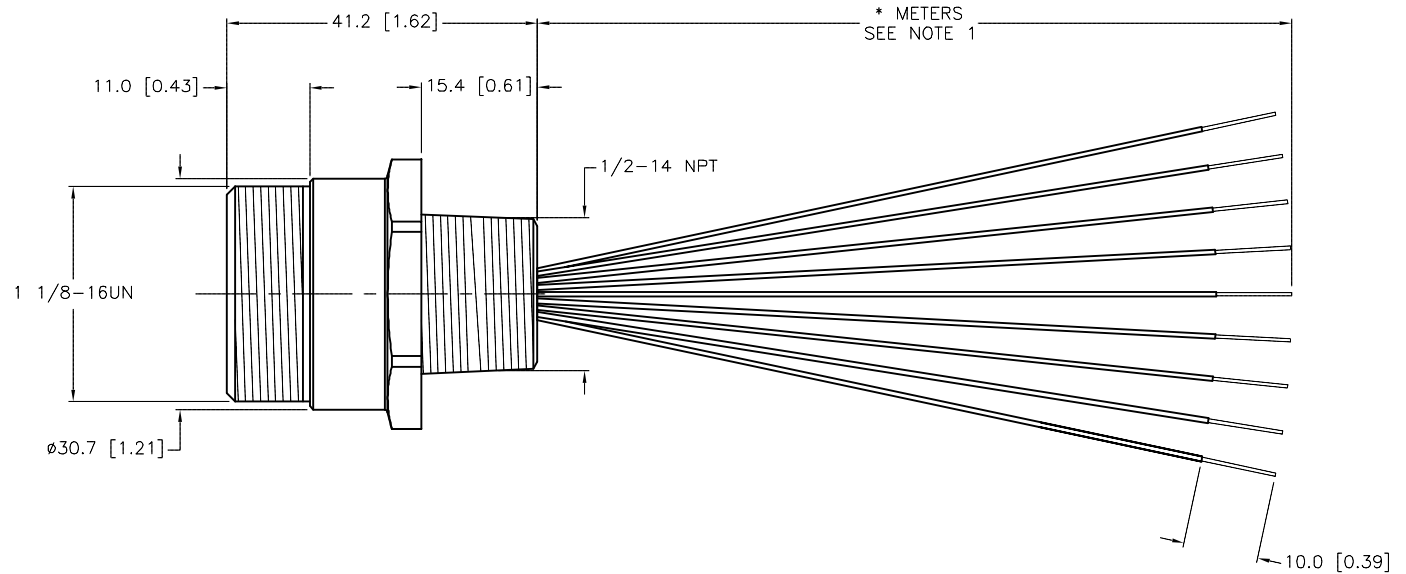
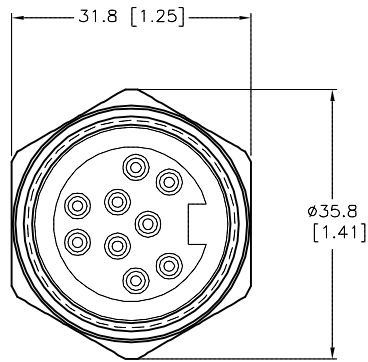

| CABLE LENGTH | TOLERANCE *   |
|--------------|---|
| ALL LENGTHS  | + 4% (OR 50mm) OF LENGTH<br>- 0% (OR 0mm) OF LENGTH<br>WHICHEVER IS GREATER |
| STRIP LENGTH | TOLERANCE *   |
| 0-7mm        | ±0.5mm  |
| 8-29mm       | ±1.0mm  |
| 30-49mm      | ±2.0mm  |
| 50-69mm      | ±3.0mm  |
| 70-100mm     | ±4.0mm  |
| OVER 100mm   | ±5.0mm  |

\* UNLESS OTHERWISE SPECIFIED

NOTES:

- "\*" INDICATES CABLE LENGTH IN METERS. CONTACT TURCK TO ORDER SPECIFIC LENGTH.

SOURCE DRAWING - FOR REFERENCE ONLY

|                   |   |  |  |                                   |
|-------------------|---|--|--|-----------------------------------|
| RELATED DOCUMENTS | 3RD ANGLE PROJECTION  | THIS DRAWING IS CONFIDENTIAL AND THE PROPERTY OF TURCK INC. USE OF THIS DOCUMENT WITHOUT WRITTEN PERMISSION IS PROHIBITED. | <p>3000 CAMPUS DRIVE<br/>MINNEAPOLIS, MN 55441<br/>1-800-544-7769<br/>(763) 553-7300<br/>(763) 553-0708 fax<br/>www.turck.us</p> |                                   |
| 1.                |   | DRFT   | DATE 12/09/13  | DESCRIPTION<br>RSF 94-*M/14.5/NPT |
| 2.                |   | KMY  | SCALE 1=1.0  |                                   |
| 3.                | ALL DIMENSIONS DISPLAYED ON THIS DRAWING ARE FOR REFERENCE ONLY<br><br>CONTACT TURCK FOR MORE INFORMATION | APVD   | N.M.   | IDENTIFICATION NO.                |
| 4.                |   | UNIT OF MEASUREMENT<br><b>MILLIMETER [ INCH ]</b>  |  |                                   |
| MATERIAL          | SEE SPECIFICATIONS  | DO NOT SCALE THIS DRAWING  |  | FILE: 777032975                   |
| FINISH            | SEE SPECIFICATIONS  |  |  | SHEET 1 OF 1                      |

|     |                          |     |          |         |
|-----|--------------------------|-----|----------|---------|
| E   | UPDATE TO POWERFAST LOGO | RDS | 01/12/18 | 63804   |
| REV | DESCRIPTION              | BY  | DATE     | ECO NO. |